



update

project update information

week of 20 April 2009

taking shape

WORK COMPLETED LAST WEEK:

- The kerb and channel between SBS and the Fox and Hounds has been constructed
- The nib kerb outside SBS Bank has been completed
- Reinstatement and surfacing of the pavement alongside the newly constructed kerb and channel has been completed
- Construction of the 300mm wide slot drain outside BNZ bank has been completed
- Paving works outside BNZ bank has commenced
- The exposed aggregate panels outside Wilson's car park have been constructed
- Site cleaned and carriageway re-opened for the V8 weekend

PLANNED WORK FOR THIS WEEK:

- Reinstate the road closure between Alma and Collingwood Street
- Remove the existing median island between SBS Bank and the Fox and Hounds
- Commence construction of the kerb 'build-out' areas
- Construct the new island kerbing at the Collingwood/Victoria Street intersection
- Commence base preparation for the new median island kerbing
- Commence construction of the new paving bands outside Wilson's car park
- Continue with base preparation and new paving works outside BNZ Bank

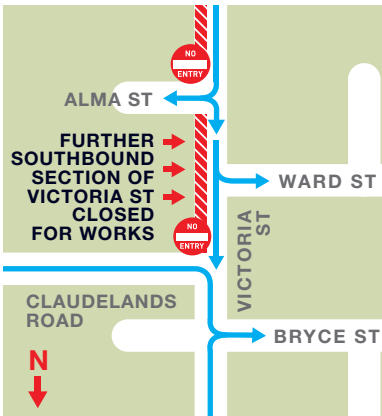

lane closures for Victoria Street

The southbound lane of Victoria Street between Alma Street and Collingwood Street was reopened last Wednesday evening for the V8s weekend. It was closed again at 9 am on Monday morning to allow the CityHeart works to continue.

To keep to programme we will be extending the closure of the southbound lane of

Victoria Street from Alma Street back to the Claudelands Road intersection. This new closure will be put into effect from next Monday, 27 April at 9 am.

We continue to make good progress and are on course to remove these lane closures and restore Victoria Street to two-way traffic by the end of June.



weekly meetings

THIS WEEK Come along to Alma Café, Tainui Novotel Hotel, Alma St
WHEN Wed 22 April 09, 2.30pm